



Explore • Discover
grow

A Faith-Based
Early Childhood Conference

Geyer Springs First Baptist Church
Little Rock

August 1, 2024

Location Information

The General Sessions will be in the Worship Center. Breakfast and Lunch will be in Sanders Hall.

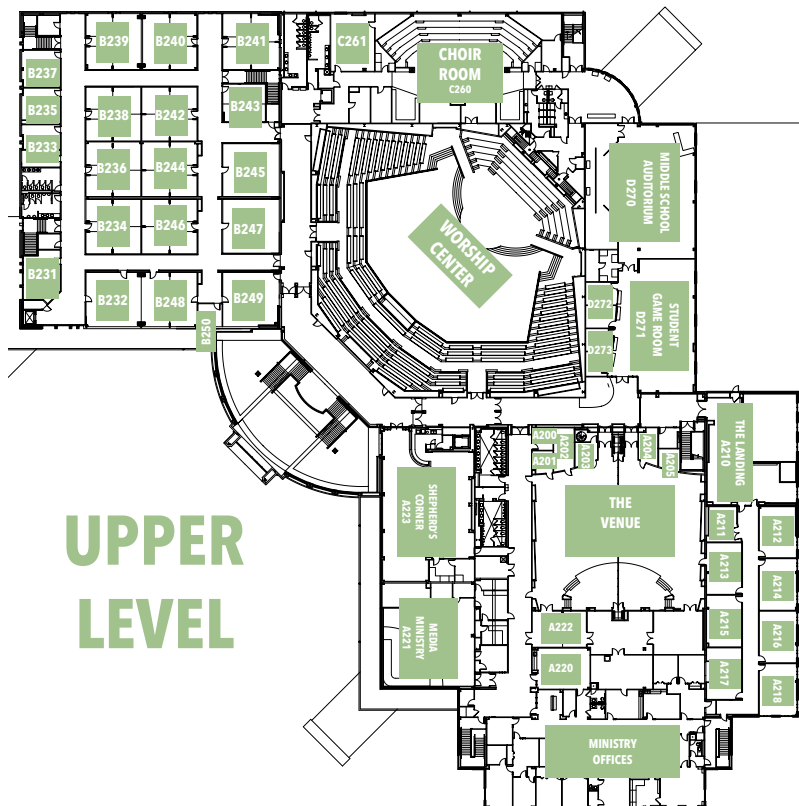
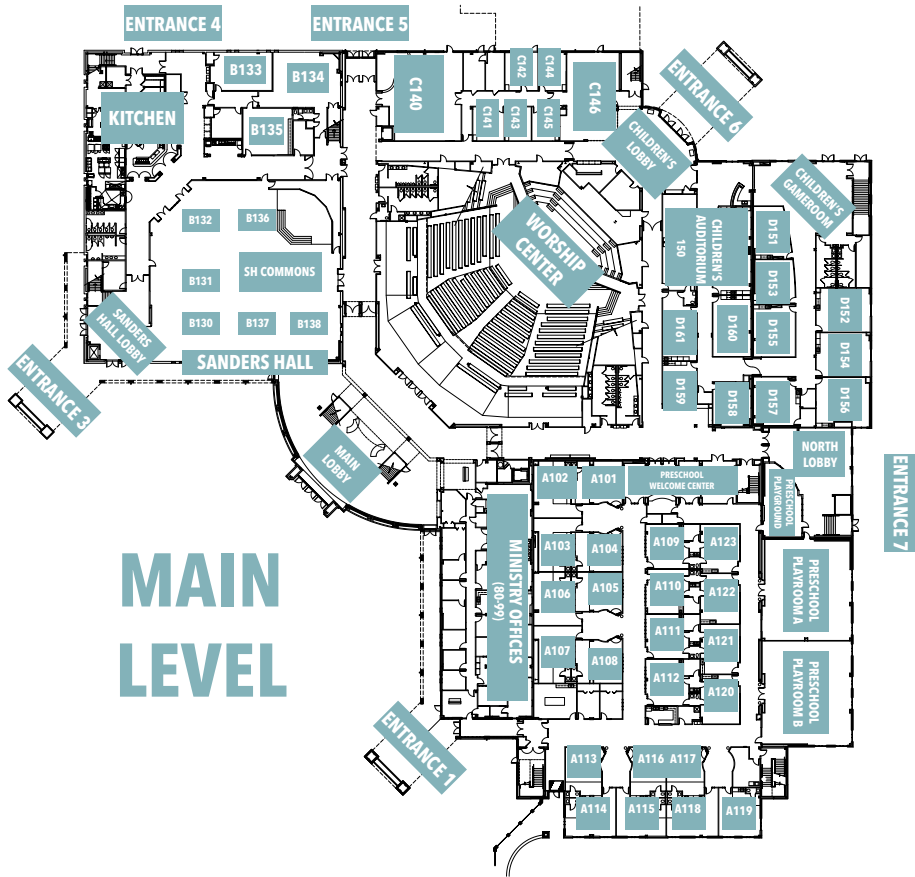

Explore Discover Grow 2024

To help ensure a productive and enjoyable experience, please be mindful of the considerations provided in this program.

Schedule

The schedule and course descriptions will guide you in choosing breakout sessions. Plan a second choice for session times.

Considerations

Please be mindful of others and our host church throughout the day. During the sessions, please silence your cell phones. If you need to take a call, please step outside of the room before answering.

Food Services

Coffee, juice, and a light breakfast will be served from 7:45-8:15 AM in Sanders Hall. Lunch will be served in this area also. Snacks will be served during the specified time in the program.

Documentation

You will find a training documentation form and certificate at the back of the program book. These forms are provided for attendees who need a record of their attendance for professional development training hours. In order to receive credit for your training hours, please have your center director submit your training documentation to the ABSC office by September 1, 2024. To receive credit for attendance in a session, participants must be present for the entire 1-hour session and include on your document the correct code word provided by the presenter at the end of the session.

Evaluations

At the end of the conference, place your EVALUATION FORM in the designated box by the registration area as you leave. We appreciate your thoughts and opinions.

Special Thanks

We would like to thank Pastor Dave Hughey, Lisa Cobb, Doug Shelby, and the entire staff of Geyer Springs FBC for their hospitality and assistance in preparing for this conference.

Schedule

7:45 AM **Registration/Breakfast**

8:30 AM **General Session** | Worship Center
Embracing God's Hope, Peace, and Power—Andrea Lennon

9:40 AM **Breakout Session 1**

1st Choice: _____

2nd Choice: _____

10:50 AM **Breakout Session 2**

1st Choice: _____

2nd Choice: _____

11:50 AM **Lunch & Networking** | Sanders Hall

12:30 PM **General Session** | Worship Center
My Class Acts Like Wild Monkeys—Mark Jones

1:40 PM **Breakout Session 3**

1st Choice: _____

2nd Choice: _____

2:40 PM **Snacks Available**

2:50 PM **Breakout Session 4**

1st Choice: _____

2nd Choice: _____

4:00 PM **Breakout Session 5**

1st Choice: _____

2nd Choice: _____

5:00 PM **Dismiss**

Notes

- A facility map is located at the front of the program to help you.
- The "target age" refers to the age-group focus for the session.
- An "X" in the column under the session time indicates the times the session is offered.
- If a session is filled when you get there, please be ready to make another selection.

Breakout Schedule

SESSION TITLE	ROOM	TARGET AGE	9:40	10:50	1:40	2:50	4:00
Classroom Centers & Setup Stacey Bullington	Preschool Playroom B	3's, PreK	X				
There's No Such Thing as a Bad Kid Kelly Day	B239/240	All			X		X
Playful Purposeful Puppets Mandi Edmonds	B241	Toddlers, 2's, 3's, PreK			X	X	
Faithful Compassion Kathy Faulkner	B249	All		X		X	
Joyful Bible Lessons for Toddlers Ally Freeman	B246	Infants, Toddlers			X		X
Learning Through Play Ally Freeman	B246	Infants, Toddlers		X		X	
The Six Critical Areas/DHS-Part 1 Kendre Harper	B239/240	All	X				
The Six Critical Areas/DHS-Part 2 Kendre Harper	B239/240	All		X			
Cultivating Empathy Lindsey Harrison-Bixler	B247	Directors, 3's, PreK, K, & School Age	X				X
Facilitating Problem Solving Lindsey Harrison-Bixler	B247	3's, PreK, K, & School Age		X		X	
Navigating Stress Using Personality Type Mollie Ipsen & Julie Yarberry	B241	All	X				
Director's Roundtable Mollie Ipsen & Julie Yarberry	B241	Directors		X			
Teaching Sign Language to Preverbal Infants Mark Jones	B232/B248	Directors, Infants, Toddlers, & 2's					X
Fine-Tuning Your Teacher Superpower Mark Jones	B232/B248	All				X	
Games for Preschoolers Mark Jones	B232/B248	All			X		
Ten Ways to Jumpstart Your Day Andrea Lennon	B232/B248	All	X	X			
Are You a Baby/Child Whisperer? Michelle Shannon	Student Game room/D271	Infants, Toddlers, & 2's	X				X
Exploring Emotions Through Art Michelle Shannon	Student Game room/D271	Directors, 3's, PreK, K, & School Age		X	X		
How to BE an A+ Teacher Emily Smith	B242	All	X				
Band-Aids, Boo-Boos, & Safety Aids Emily Smith	B242	All					X
Inviting Infants & Toddlers to Play Marcy White	C140	Infants, Toddlers, & 2's			X		
Using Books to Support & Extend Learning Marcy White	C140	Toddlers, 2's, 3's, PreK, & K				X	
Why They Do the Things They Do Marcy White	C140	All		X			

Breakout Descriptions

Descriptions are listed alphabetically by presenters' last names.

Stacey Bullington

Preschool Teacher, Geyer Springs FBC

Classroom Centers & Setup | *Category: All*

Discover how using centers can provide opportunities for children to grow and learn through play. See different setups in age-based classrooms. *Space is limited.*

Kelly Day

Counselor, Texarkana ISD - Morriss Elementary

There's No Such Thing as a Bad Kid | *Category: All*

The value of a child is not rooted in the behavior of a child. All children, even those with challenging behaviors, are a gift the Lord created in His image. What do we do when the "gifts" they have been given disrupt the learning environment in our classrooms? This workshop focuses on the importance of developing positive relationships, understanding why children behave the way they do, and strategies that promote social and emotional development.

Mandi Edmonds

Project Specialist/Trainer/Curriculum Coach, A-State Childhood Services

Playful Purposeful Puppets | *Category: Toddlers, 2's, 3's, PreK*

Join us in this interactive session to learn a few tips about when and how to use puppets. Discover three big benefits of puppet use in early childhood education environments. Puppets are powerful!

Kathy Faulkner

Behavior Interventionist, Greene County Tech

Faithful Compassion: Empowering Preschoolers Through Behavior and Empathy | *Category: All*

Ministering to difficult kids through empathy and heartfelt connection involves building trust, understanding their challenges deeply, and providing compassionate support to nurture their growth and well-being.

Ally Freeman

Family Minister, Grand Avenue Baptist Church, Fort Smith

Joyful Bible Lessons for Toddlers | *Category: Infants & Toddlers*

Learning Bible stories can be an enjoyable experience for toddlers and their teachers when you use fun activities, colorful illustrations, and simple age-appropriate language. Discover how to teach a solid foundation in biblical truths, while helping toddlers develop a love for God's Word.

Learning Through Play: Finding the Balance & Keeping Peace in Your Classroom

Category: Infants & Toddlers

Let's explore the various learning styles of young children and emphasize the importance of play as a crucial component of early childhood development. Discover effective strategies to integrate educational concepts into playtime and make learning both enjoyable and impactful. Learn techniques for gentle redirection, which help to manage challenging behaviors while maintaining a positive and nurturing environment. Join us to gain practical tools and knowledge for supporting toddlers' growth and development through balanced and purposeful play to keep a peaceful classroom.

Kendre Harper

Child Care Service Specialist, Arkansas DHS

The Six Critical Areas of Child Care Licensing-Part 1 | *Category: All*

During this session we will review the six critical areas of the Minimum Licensing Requirements for Child Care Centers in Arkansas. We will discuss the ways to increase awareness and understanding of critical deficiencies that impact the health and safety of children in care. This session is designed to strengthen the overall compliance level of the facility.

The Six Critical Areas of Child Care Liscensing-Part 2 | *Category: All*

This session is a continuation of Part 1: During this session we will continue to discuss the 6 critical areas of the Minimum Licensing Requirements for Child Care Centers in Arkansas. We will continue to discussing ways to increase awareness and understanding of critical deficiencies that impact the health and safety of children in care. We will continue to discuss ways to strengthen the overall compliance level of the facility.

Lindsey Harrison-Bixler

Out of School Time Quality Supports Coordinator, ASU Childhood Services

Cultivating Empathy | *Category: Directors, 3's, PreK, K, School-Age*

By incorporating and modeling empathy, leaders can add value to their programs and promote positive skill-building for young people. In this session, participants will practice strategies for supporting empathy building, including active listening skills that model empathy and encourage young people to express their emotions in a healthy way. Participants will also explore best practices for supporting empathy building in programming and plan next steps for incorporating these concepts into their work with young people.

Facilitating Problem Solving | *Category: 3's, PreK, K, School-age*

Problem solving is the ability to plan, strategize & implement complex tasks. Leaders have the opportunity each day to build problem solving opportunities into programs and support young people with in-the-moment problem solving, all to support skill building. In this workshop, participants will learn the basics of how our brain solves problems, and will practice a model for helping young people define and explore problems, preparing them to take action and learn from them. Participants will apply the skills and content to problem-solving with young people in their context.

Mollie Ipsen & Julie Yarberry

Better Beginnings Project Specialist – Arkansas State University

Director's Roundtable | *Category: Directors*

Join us for a time designated for networking, question and answers, and discussing current topics in weekday education.

Navigating Stress Using Your Personality Style | *Category: All*

We all have stress in our lives. See how your personality style can help you navigate your stress to bring you joy.

Mark Jones

Children's Pastor, Quail Springs Baptist Church, OKC | mrmarksclassroom.com

Keynote- My Class Acts Like Wild Monkeys | *Category: All*

Children need to know our expectations and the framework of our class procedures to be more successful and productive in the classroom. Teachers will learn key procedures to lead their children and tame the monkey business.

Fine-Tuning Your Teacher Superpower | *Category: All*

Teachers have superpowers that really connect with kids, but they have not discovered them yet. Learn the amazing things you can do that will lead kids to better participation and relationships with you and others.

Games for Preschoolers | *Category: All*

Playing group games can be the highlight of the day but teachers need game ideas. Come get great ideas you can use with your class immediately. These learning games are great fun to play over and over again. Take special note of the games with no props, perfect for emergency situations to stretch your time with kids.

Teaching Sign Language to Preverbal Infants | *Category: Directors, Infants, Toddlers, 2's*

Infants develop the ability to sign much sooner than speaking. When teachers and caregivers practice these signs in their communication, the child will feel more secure and ultimately learn to speak sooner. Come learn 25 words/ phrases and how to teach them to your infants. Teaching infants to sign has to be one of the great rewards as a teacher.

Andrea Lennon

Speaker and Author, Andrea Lennon Ministry

Embracing God's Hope, Peace, and Power | *Category: All*

Life can be hard! Sometimes we have more questions than answers. Doubt and fear can creep into our hearts and steal our focus. Thankfully, we don't have to stay in a place of struggle. We can experience God's hope, peace, and power no matter the situations we face. Hear powerful truths found in Romans 15:13 and how God's hope, peace, and power are available to us as we trust in Him!

Ten Ways to Jumpstart Your Day with Jesus | *Category: All*

Do you feel stuck in your walk with God? If so, discover down to earth ways to jumpstart spiritual growth in your daily life. You don't have to settle for an ordinary relationship with God. You can have a thriving relationship with God that is about living with your eyes and heart focused on Jesus. These easy to implement actions will be game changers in your daily walk!

Michelle Shannon

Preschool Director, Central Baptist Church, Jonesboro

Are You a Baby/Child Whisperer? | *Category: Infants, Toddlers, 2's*

Discover ways to care for children and make sure they are happy, confident, healthy and cooperative by understanding and responding to their inner nature.

Exploring Emotions Through Art | *Category: Directors, Toddlers, 2's, 3's, PreK, K, School-age*

Does your artwork often show how you are feeling? Join us for this hands-on artful experience.

Emily Smith

Children's Specialist & Abuse Prevention + Response Consultant, Arkansas Baptist State Convention

How to BE an A+ Teacher | *Category: All*

Laying Biblical foundations in the lives of babies and preschoolers is vital in their spiritual development. Discover 10 ways you, as a teacher, can BE effective in helping build on this foundation as you teach.

Band-Aids, Boo-Boos, & Safety Aids, Oh My! | *Category: All*

Heads, shoulders, knees, and toes, and the faster we go! Let's explore safety tips and aids to avoid all the Band-Aids, boo-boos, and woes that are common in working with preschoolers.

Marcy White

Project Coordinator, A-State Childhood Services

Inviting Infants and Toddlers to Play | *Category: Infants, Toddlers, 2's*

Join us to consider some super-simple ways to optimize engagement and create opportunities to extend learning with mobile infants, toddlers, and 2's. We'll discuss ways to create invitations to play and strategies for interacting with children.

Using Books to Support and Extend Children's Learning | *Category: Toddler, 2's, 3's, PreK, K*

Join us to explore a beautiful collection of picture books as we think together about how "the right book at the right time" can draw out children's knowledge, answer their questions, foster classroom community, and reflect their newfound expertise.

Schemas of Play: Why They Do the Things They Do | *Category: All*

When we visit a group of children at play, we expect to see children stacking block towers, rocking baby dolls, and drawing pictures. What is going on with the kids who play in different ways, such as climbing into the shelves, piling up all of the play dishes, or emptying the entire glue bottle?! Children's schema-related behaviors are often surprising and sometimes challenging. In this session, we'll become familiar with common schemas, consider their role in child development, and fine-tune classroom practices to guide and support schema-related behaviors.

Explore • Discover • **grōw**

2024 PLANNING TEAM

Erin Alexander | Trinity Baptist Church, Texarkana

April Brown | First Baptist Church, Rogers

Lisa Cobb | Geyer Springs First Baptist Church, Little Rock

Joan Hubbard | First Baptist Church, Siloam Springs

Michelle Shannon | Central Baptist Church, Jonesboro

Melissa Smith | Park Hill Baptist Church, North Little Rock

Emily Smith | Arkansas Baptist State Convention

Explore • Discover • Grow is a ministry of the Arkansas Baptist State Convention made possible through the Cooperative Program.



For more information contact:
Evangelism + Church Health | 10 Remington Dr. | Little Rock, AR 72204
1-800-838-2272 | 501-376-4791 | absc.org/weekday